

## Situation with average sizes of pins and pinholes.

Step 1. Bearing cap not correctly aligned before machining.  
Caused by: wrong / too small locating pins.  
This results in: rotation between upper and lower part.

Startingpoint for calculations are:

1. Bearing cap mounted with wrong locating pins (8h8 instead of 8m6) and maximum misalignment possible.  
Connecting rod pinhole bore: ~~8F7 nominal (8,0205)~~  
Bearing cap pinhole bore: ~~8H7 nominal (8,0075)~~  
Pin diameter: ~~8h8 nominal (7,989)~~

Average

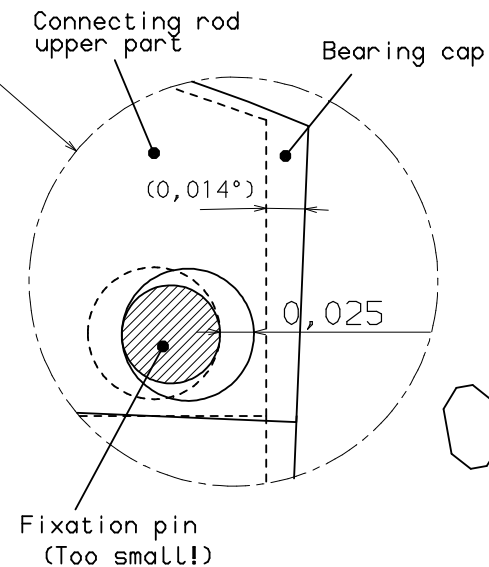
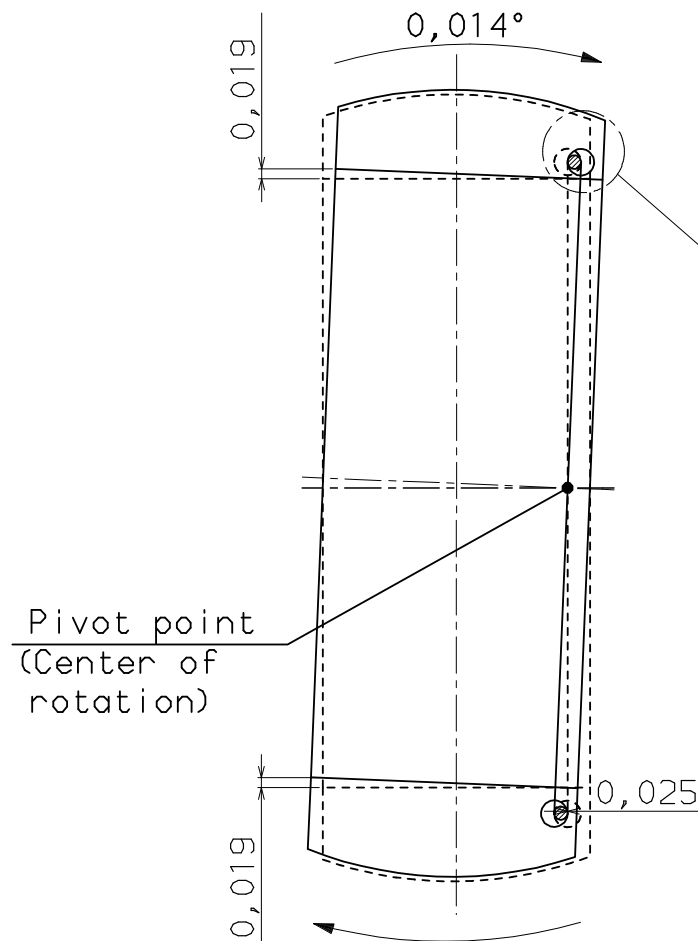

EUROPEAN PROJECTION